

## How to perform the test

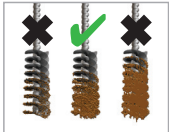

1  
Mix specimen thoroughly. Collect specimen using Sample Collection Brush.



Rotate brush over specimen surface to lightly coat the surfaces of the brush bristles.

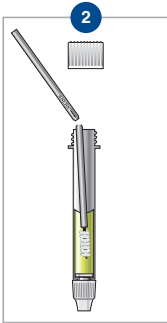

2  
Insert brush into Sample Preparation Apparatus. Break off brush at the "Break" mark on the handle. Recap and vortex 10 seconds.

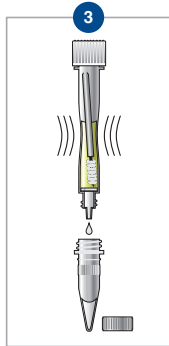

3  
Remove cap and squeeze 5-10 drops of sample into Heat Treatment Tube.

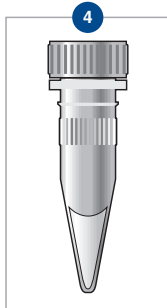

4  
Heat the *illumigene*<sup>®</sup> Heat Treatment Tube at 95 C for 10 minutes. Vortex for 10 seconds.



5  
Transfer 50  $\mu$ L of heat-treated sample to the Reaction Buffer Tube. Vortex for 10 seconds.

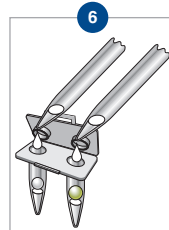

6  
Using a new pipette tip for each, transfer 50  $\mu$ L of the Reaction Buffer Tube sample to the TEST and CONTROL chamber of the *illumigene*<sup>®</sup> Test Device.

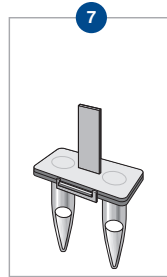

7  
Close and fasten the latch securely. Gently tap device to remove air bubbles trapped on the bottom of the tubes. Carefully examine reaction tubes to ensure that there are no air bubbles left in tube.



8  
Insert *illumigene*<sup>®</sup> Test Device into the *illumipro-10*<sup>™</sup> and initiate amplification reaction and detection.



This illustration is representative of the current Package Insert at the time of publication. Please refer to the most current version of the package insert for complete instructions.